



**All Good questions! If you are concerned about the answers, there is a better way!**  
Now you have an option!

- Was the surface clean when the flashing tape was applied?
- Was the wood substrate really dry?
- Were the substrates primed?
- Was a positive slope installed to the outside and/or a proper back dam created?
- Was a positive slope installed to prevent any leaks in this critical area?
- Was the Weather Resistant Barrier (WRB), i.e. Houswrap, properly tied-in to our flashing systems?

**Are you concerned that although you designed it well, there are factors out of your control that will affect your window and door INVESTMENT?**

For some years now, common practice in Residential or light Commercial construction has been to Flash / Waterproof a window or door rough opening with Rubberized Asphalt or Butyl based flashing tape. This is also the case with sheet Water Resistant Barriers that have been prevalent in the market for decades. An excellent practice adopted by builders and contractors around the country. But like many things in life, technology has advanced and brought us a Better Way!



**Blue Barrier™  
Flash 'N Wrap™ 2400**  
*Weather proofing your house ...  
There's a better way!*

**Installation Instructions**  
Building Envelope Protection Membrane



**INSTALLATION NOTE:** Field application should be completed prior to setting the Window/ Door package.

**"Moisture and Air Stop Here®"**

Information at [www.poly-wall.com](http://www.poly-wall.com) for our full array of product offerings.

**888-976-POLY (7659)  
info@poly-wall.com**



This is a fluid applied coating that is applied over common substrates such as OSB, plywood, CMU and exterior gypsum, creating a seamless, durable, permanent waterproofing platform to protect your investment.

## BLUE BARRIER™ FLASH 'N WRAP™ 2400

Our parent company, Polyguard Products has been manufacturing and marketing water and corrosion resistant products to the Pipeline, Mechanical and Architectural construction industries in some cases for over 60 years. We have 21 patents to our credit and millions of square feet of installations across North America and in 30-plus countries. "Made in the USA", employee owned company has designed, engineered and sized offerings for the residential and light commercial construction markets and applications.

## Introducing PolyWall® Building Solutions BLUE BARRIER™

### Blue Barrier™ Flash 'N Wrap™ 2400

TYPICAL PROPERTIES - Cured Properties at 21 days	
Hardness, Shore A	55-65
Tensile Strength	300-350 psi
Elongation	200-250%
Tear Strength	40-50 psi
Peel Strength	25 PLI
Perm Rating	23 Perms at 12 mils
UV Exposure	12 Months when used as window/door flashing
UV Exposure	6 Months when used as an air barrier

Uncured Properties	
Tack Free Time	<60 minutes
Cure Rate	1/8" - 16hrs.
VOC Content	<30g/liter
Coverage Rate	100 s/f per gallon

*Note: Cure rates will vary based upon the relative humidity of the application environment.*

SIZE	PART NUMBER
2 Gallon Pail	PWBB.2400.FNW.2
5 Gallon Pail	PWBB.2400.FNW.5

#### CONSIDERATIONS:

- For optimum results, we recommend this product be applied in 40°F and rising temperatures.
- Poly Wall Blue Barrier Flash 'N Wrap 2400, and detailing products can be applied to damp substrates and in damp atmospheric conditions. However, Blue Barrier products should not be applied to any substrate in heavy rain conditions where water is directly hitting the substrate during application or water is flowing over the substrate to which the product is being applied.
- Blue Barrier products are not designed to be used on Borate treated lumber.
- Properly dispose of any roller covers and brushes as they will not be reused or cleaned. If you used the plastic trowel or putty knife allow for the product to cure and peel off for the next use.
- Approved Solvents: Mineral Spirits, Denatured Alcohol, VM&P, Methyl Acetate (VOC Exempt).
- Apply as packaged, Do not dilute or alter.
- Stains from substrate may transfer due to permeability of product but will not alter performance of product.
- Due to the wide variety and composition of substrates, preparation methods, application methods and environments, always test a small area to validate desired result.



**"Moisture and Air Stop Here®"**  
888-976-7659 • info@poly-wall.com

- Superior finished hardness...your windows and doors will not damage it when installed
- Has elongation properties that allow it to stretch over small cracks
- Seamless...no worries about reverse shingling or a torn sill pan flashing
- Permeable...allows substrates to dry / breathe
- Moisture cured...can be applied on damp surfaces (i.e.: after a rain / not during it)
- Simple to install...roller applied
- No mixing needed
- Tenaciously bonds to all commonly available sheathing products and framing components
- Environmentally friendly...Low VOC's (less than 30 g /liter)
- UV Resistant...can be left exposed for up to 12 months
- Improves job productivity...windows and doors can be installed in 30 minutes after waterproofing
- Time-tested results this same technology has been used in Commercial Construction for years

## BLUE BARRIER™ FLASH 'N WRAP™ 2400

### Installation Progress on Windows



**INSTALLATION NOTE:** All openings and voids are to be filled flush with Blue Barrier Joint Filler 2200.



**INSTALLATION NOTE:** Be sure to use a 4- or 6-inch, hot-dog-style roller handle and mini roller with a high density foam cover that will give you the best yields and coverage.



**LIMITED WARRANTY:** Poly Wall Building Solutions will replace F.O.B. Ennis, TX, any material with manufacturing defects which cause leaks for a period of 1 year from date of purchase. Poly Wall Products will not be liable for any other claims or damages, whether direct or indirect, including consequential damages or incidental damages.

## Tools/Materials Needed

- 2- or 5-gallon pail of Poly Wall Blue Barrier Flash 'N Wrap 2400
- 10.1 oz caulking or 20 oz. sausage tube of Poly Wall Blue Barrier Joint Filler 2200
- Caulking gun
- Chip Brush
- 4- or 6-inch, hot-dog-style roller handle and mini roller. (Roller pad has a small hole to accept handle.) Using a 4- or 6-inch hot-dog-style roller handle and a high density foam cover will give you the best yields and coverage. The roller width is dependent on the framing around your window ... a 4-inch roller for 2x4 construction, a 6-inch roller for 2x6 construction is more convenient, both will work.
- 2- to 4-inch plastic putty knife or trowel. Plastic cleans easier in this application than metal.
- Optional: A piece of beveled siding sized to your rough opening to provide positive slope.

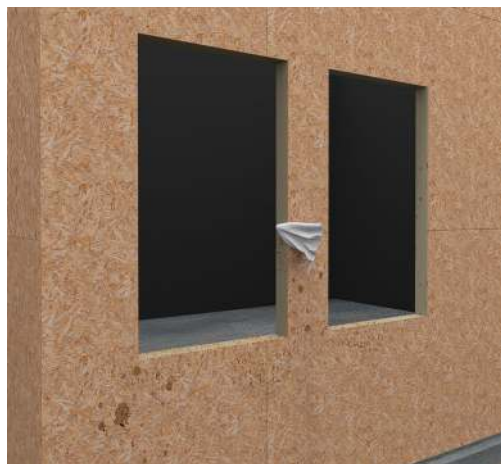

### STEP 1

Clean & Prepare the rough opening. Simply take a stiff brush followed by a damp rag and wipe away debris, sawdust, dirt or foreign matter off all surfaces including the rough opening and 6-inches around the outside perimeter of the window opening on the sheathing itself.



### STEP 2

Provide Positive Slope on the rough opening sill per Window Manufacturer's Installation Specifications. In common practice, this can be achieved by cutting a piece of beveled siding the size of the rough opening with thick side towards interior and nail in place. VERY IMPORTANT...if you choose to do this, you must account in advance for the space in the rough opening you take up with the positive slope, or your window will not fit.

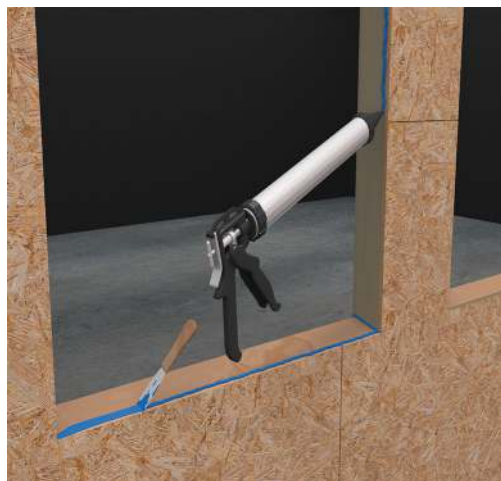

### STEP 3

Detail any void greater than 1/8-inch with Poly Wall Blue Barrier 2200 Joint Filler. This would include any dissimilar materials, cracks, imperfections. Simply apply with the caulking or sausage gun and strike smooth with the putty knife where accessible. In the corners feel free to use your index finger with a damp cloth over it. On average after 30 minutes product is ready for the next step depending on Relative Humidity and Temperature. To be sure simply place finger upon the Joint Filler. It is likely to still be "tacky" but if it does not stick to your finger you are good to go.



### STEP 4

Open the pail of Poly Wall Blue Barrier Flash 'N Wrap 2400, no stirring necessary. Remove the lid liner and save it for later use. Load the roller by dipping in bucket shaking off any excess coating material into the bucket.

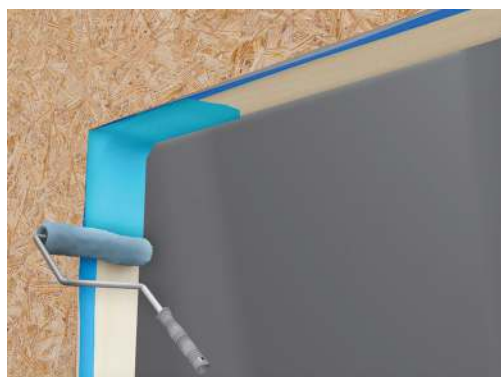

### STEP 5

Starting with the top left hand corner of the rough opening itself on the inside of the jamb from the corner, apply flashing material 6-inch down from the corner and then 6-inch over from left to right on the header. This procedure will allow you more even distribution of the coating as you take it from the bucket. Be sure to work the material into the corner. Your chip brush can be helpful for this. Maintain a uniform thickness where you can see no wood color. Common practice is to utilize a mil gauge, if you have access to one, to measure flashing thickness to 20 mils wet.



### STEP 6

Repeat on Right side...6-inches down from corner, 6-inches over on header, this time right to left and complete the corner itself. Coat the balance of the header (the middle) with flashing.



### STEP 7

Go back to left side and complete coating down the sill. Repeat on the right side. You should now have coating on both sides and the top. Again, maintain a uniform thickness where you can see no wood color which will be about 20 mils wet.



### STEP 8

Work material into the right sill corner with your roller and chip brush if needed. Be sure all wood is covered. Do the same on the left and then complete the balance of the sill.

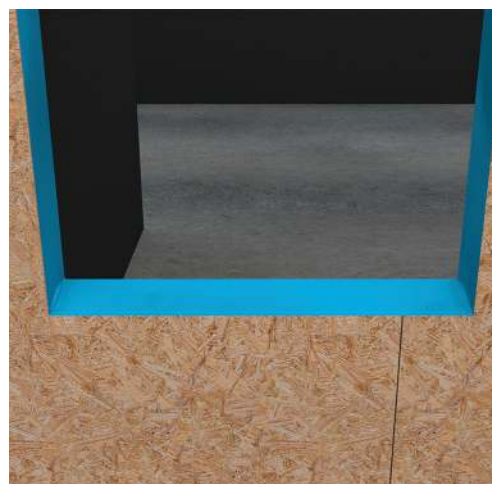

### STEP 9

If you utilized positive slope by using beveled siding, make sure you cover all areas completely with the fluid applied flashing.



### STEP 10

On the outside of the rough opening, over the sheathing itself, you are going to repeat the same procedure. You are going to apply a 4-inch or 6-inch wide (depending on your roller size) pattern of flashing around the window perimeter, so that the substrate cannot be seen any longer, which is approximately 20 mils wet.



### STEP 11

Start on the left side and proceed 6-inches down the face of the sheathing vertically, then 6-inches horizontally just above the header from left to right. Repeat on right side, then complete across the top adjacent to the header.



### STEP 12

Proceed to the left side and continue the coating down the sheathing down vertically past the sill. Do the same on the right. Finish off by applying the fluid applied flashing horizontal over the sheathing adjacent to the sill. You should now have at least a 4-inch coating of Poly Wall Blue Barrier Flash 'N Wrap 2400 which is approximately 20 mils thick. (You can't see any substrate or sheathing under the material.) If you can, go back and "touch those areas up."

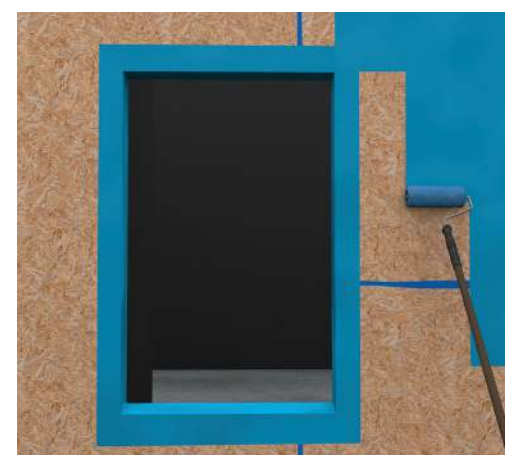

### STEP 13

To provide a weather resistant barrier to your exterior wall, simply roll Blue Barrier Flash 'N Wrap 2400 on the wall with a high density foam roller (utilizing a chip brush when needed) after cleaning and preparing the substrate as shown in Step 1. Common practice is to utilize a mil gauge, if you have access to one, to measure weather barrier thickness to 20 mils wet.

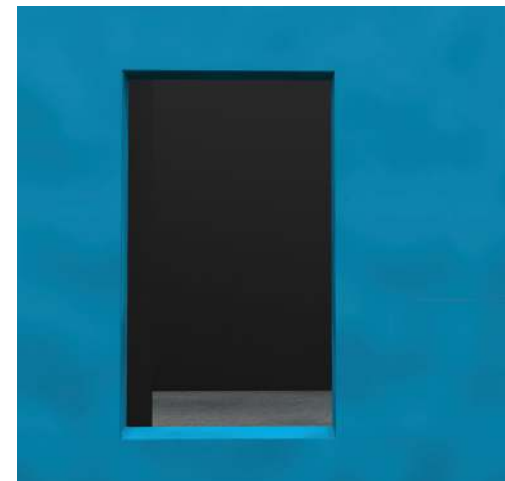

### STEP 14

Allow approximately 30 minutes for the product to set up depending on relative humidity and temperature. It may still be tacky; but, as long as the product does not attach to your finger at touch, you are ready to install your window.



### STEP 15

Install your window or door per manufacturer's specifications and instructions. Many manufacturers call for a compatible sealant to be applied prior to the window being installed into the opening. Poly Wall Blue Barrier 2200 Joint Filler can be used for this purpose. Apply as you would another sealant with a caulking or sausage gun to the top and sides of the opening prior to installation of the window.

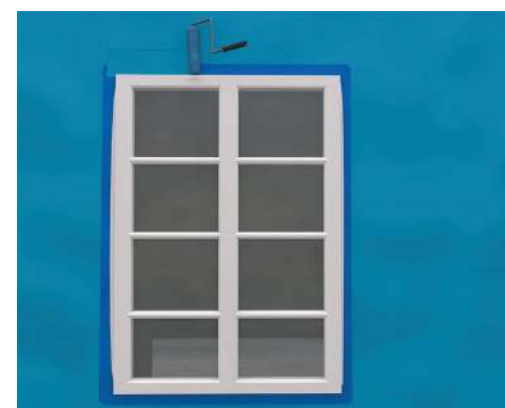

### STEP 16

After Window has been installed as directed by manufacturer specifications, apply Poly Wall Blue Barrier Flash 'N Wrap 2400 over header flange of the window itself with your roller or brush, tying it into the existing cured fluid membrane that you had applied earlier. Make sure to completely cover the flange with fluid applied product. Masking off the window frames at this point to protect them from drips and splatters is a good idea.



### STEP 17

Repeat on the left and right sides of your window. It is important to leave the sill flange on the window at the bottom un-flashed with fluid flashing to allow moisture relief in the event of a window leakage.